

SERIES

JF35.100Q

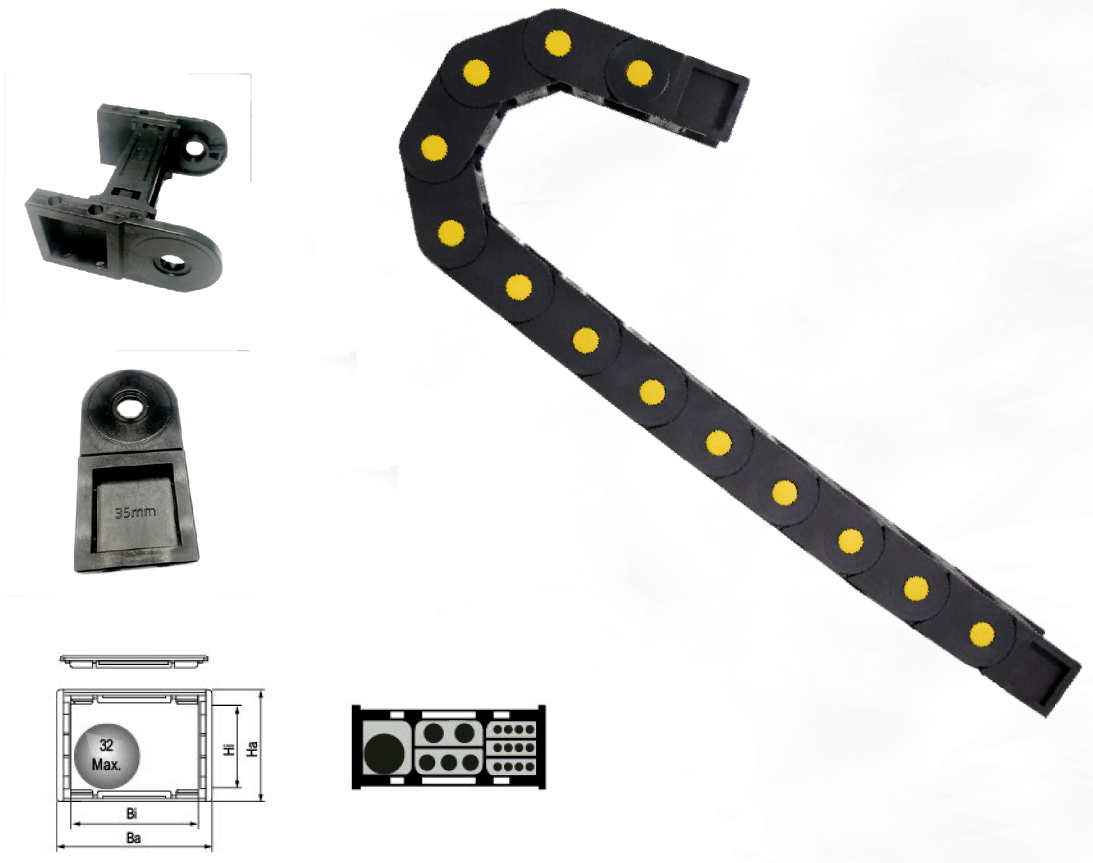

Miniature series



- The cable chain tested service life is up to 20 million times.
- The ledge of cable chain is able to open to inspect or replace cable.
- The cable chain can be mounted separator and cross separator to divide space and effectively protect cables. (See accessories table)
- The cable chain can be mounted pectinate plate to fix cable better. (See accessories table)
- The cable chain is suitable for a diameter of 32mm or less of cable.

Basic technical data

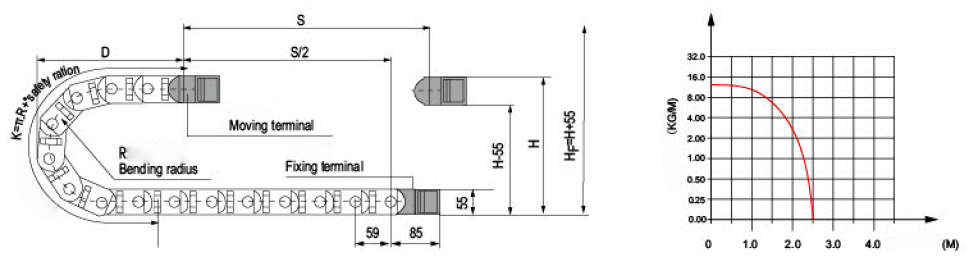

Pitch=59mm, link per meter=17, length of chain=S/2+K, S=stroke. $K = \pi \cdot R + \text{"safety ration"}$

R	75	100	125	150	200	250
H	205	255	305	355	455	555
D	162	187	212	237	287	337
K	354	472	531	590	767	944

Actual mounting height: $H_f = H + 55\text{mm}$ (load 1.0kg/m)



Series No.	Hi	Bi	Ha	Ba	Styles	Bending radius R	Bracket type and parameters						
							(mm)hole distance						No.
							A	B	C	D	E	F	
JF35.60Q	35	60	55	85	Q	100	24	76	26	15	89	JF35.60Q	
JF35.75Q	35	75	55	100	Q	100	24	91	26	15	104	JF35.75Q	
JF35.100Q	35	100	55	125	Q	100	24	116	26	15	129	JF35.100Q	

Fix bracket type and parameters

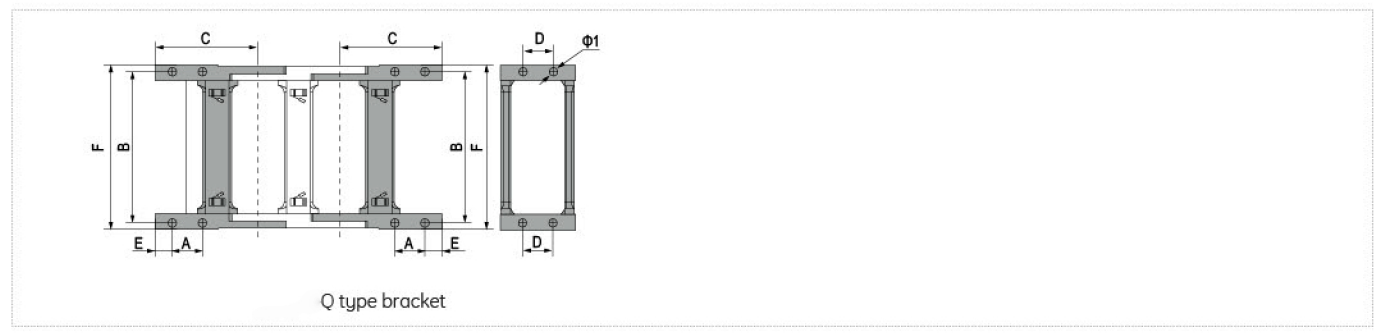

Order Sample
 (Sample: inner height 35mm, inner width 50mm, radius 75mm, length 17 links/1 meter)

Note: Various sizes can be customized according to customer requirements.



MADE IN TURKEY